

ES3™ T5 & T3-¼ Lamp Sockets



ES3™ Components provides multiple components and connection systems for the automotive exterior lighting market. ES3™ is the largest potted socket manufacturer in the world.

ES3™ manufactures a full line of S8 and T5 & T3-¼ lamp sockets. The robust design of ES3™ lamp sockets provide flexibility and a lower cost alternative to other lamp socket suppliers.

All ES3™ lamp sockets and connection systems are tested to USCAR/EWCAP requirements. ES3™ lamp sockets are also tested in a certified A2LA accredited lab, dedicated to insuring the quality and performance of all components tested.

T5 & T3-¼ Lamp Socket Attributes

- Material specified to resist heat and outgasing
- Superior bulb stability and retention
- Terminal design compatible with T5 and T3-¼ bulbs
- Available in right-angle and axial formats
- Unique, anti-crush terminal design available in September 2007.
- Patented potted sealing process allows single and double crimps
- Common terminal design for all sockets
- USCAR/EWCAP compliant
- Available in multiple focal lengths and lug patterns
- Customized focal lengths and lug patterns available
- Sealed and unsealed sockets available
- Potted and traditional seal options available

T5 & T3-¼ Lamp Sockets Available:



Axial Socket

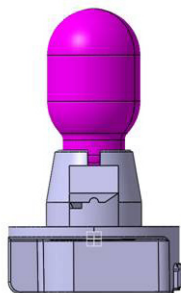

Right-Angle Socket

Additional Products Available:

- Direct Connect Sockets
- Connection Systems
- Grommets/Clips/Seals

Visit us online at
www.es3components.com



TM

T5 & T3-¼ Axial Sockets Available

FOCAL LENGTH	BULB TYPE	LUG PATTERN
10.8	T3-¼	1
11.2	T3-¼	1
15.0	T3-¼	2,3,4,5
15.1	T3-¼	6
15.5	T3-¼	7
15.6	T3-¼	6
17.2	T5	1
17.6	T5	1
21.4	T5	2,3,4,5
21.5	T5	6
22.0	T5	6
29.0	T3-¼	8
35.4	T5	8

Lug Patterns (view of inside)

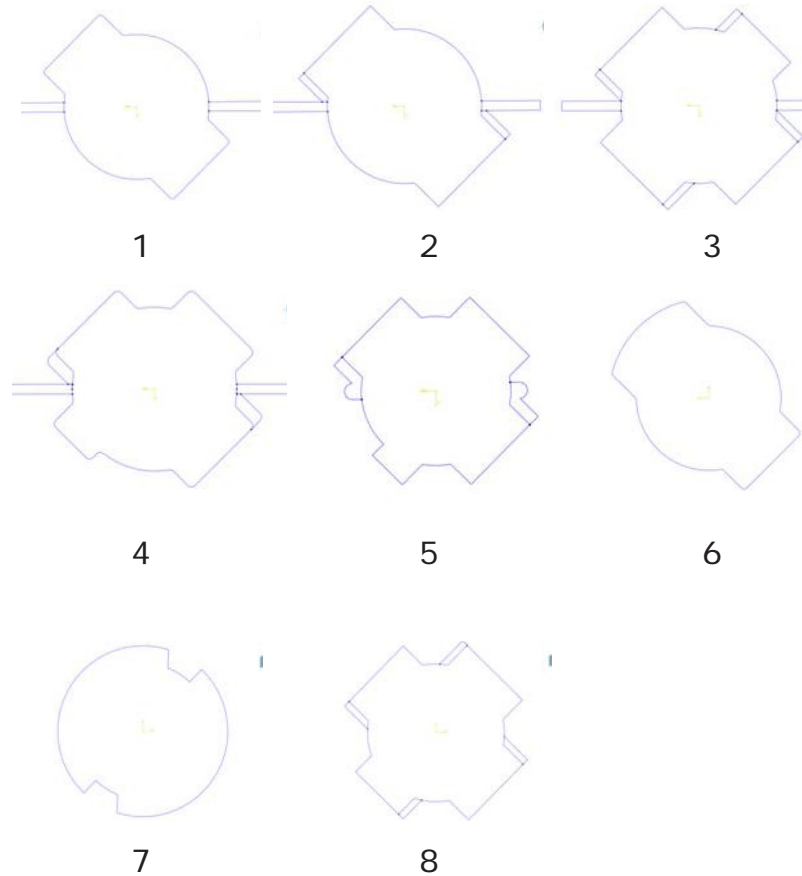

T5 & T3-¼ Right-Angle Sockets Available

FOCAL LENGTH	BULB TYPE	LUG PATTERN
15.5	T3-¼	2
15.6	T3-¼	2
21.9	T5	2
22.0	T5	2

Socket Part Numbering System

Socket Type	Focal Length	Type	Orientation	Color	Material	Lug Pattern	Bulb Key	Latch Option	Connector Mate	Terminal Option	Revision
S8	2540	D	A	BK	01	01	1	T	01	A	1

S8 = S8
T5 = T5 or T3
T20 = T20
BA = Bayonette

2085 = 20.85
2220 = 22.2
2540 = 25.4
2914 = 29.14
2945 = 29.45
3150 = 31.5
3490 = 34.9
3660 = 36.6

D = Direct Connect
P = Potted
W = Pig Tail

A = Axial
R = Right Angle

BK= Black
GY= Gray
GN= Green
NT= Natural

01 = GTX810 (Standard)
02 = NYLON 4, 6 (High Heat)
03 = LCP
04 = GRIVORY

01
02
03
04
05
06
07
08
09
10
11

1
2
3

*N/A for T5 & T3-¼ Sockets

T = Top Latch
S = Side Latch

01 = EEM0340
02 = EEM0341
03 = EEM0342
04 = EEM0343
05 = 6189-0887

a = Major, Minor, & Ground
b = Major & Ground
c = Minor & Ground

**N/A for T5 & T3-¼ Sockets

For 2 piece designs:
BKGY - Black body with Grey shell
GYBK - Gray body with Black shell
GYNT - Gray body with Natural shell
NTGY - Natural body with Gray shell

ES3™ Components

214 E. Maple Rd
Troy, MI 48083
Tel. 248-585-8130
Fax 248-585-3686

Alex Del Rio
Sales
Tel. 248-635-8969
adelrio@es3components.com

Pat Traynor
Sales
Tel. 248-709-3600
ptraynor@es3components.com

John Trembowicz
Sales
Tel. 248-705-0901
jtrembo@es3components.com

Mike Simonelli
Sales
Tel. 248-835-0516
msimonelli@es3components.com

Brad Lepczyk
Inside Sales
Tel. 248-585-8130
blepczyk@es3components.com

***Contact your ES3 representative for availability on colors, focal lengths and lug patterns.

